

# Garage Cross Section

Name \_\_\_\_\_

Permit # \_\_\_\_\_

**Insulation (if applicable):**

Ceiling: R-\_\_\_\_\_

Floor: R-\_\_\_\_\_

Wall: R-\_\_\_\_\_

\_\_\_\_\_ Check (X) If trusses are being used. Provide truss specs indicating minimum 40 PSF snow load and 115 mph wind speed. Trusses shall be installed to manufactures specifications.

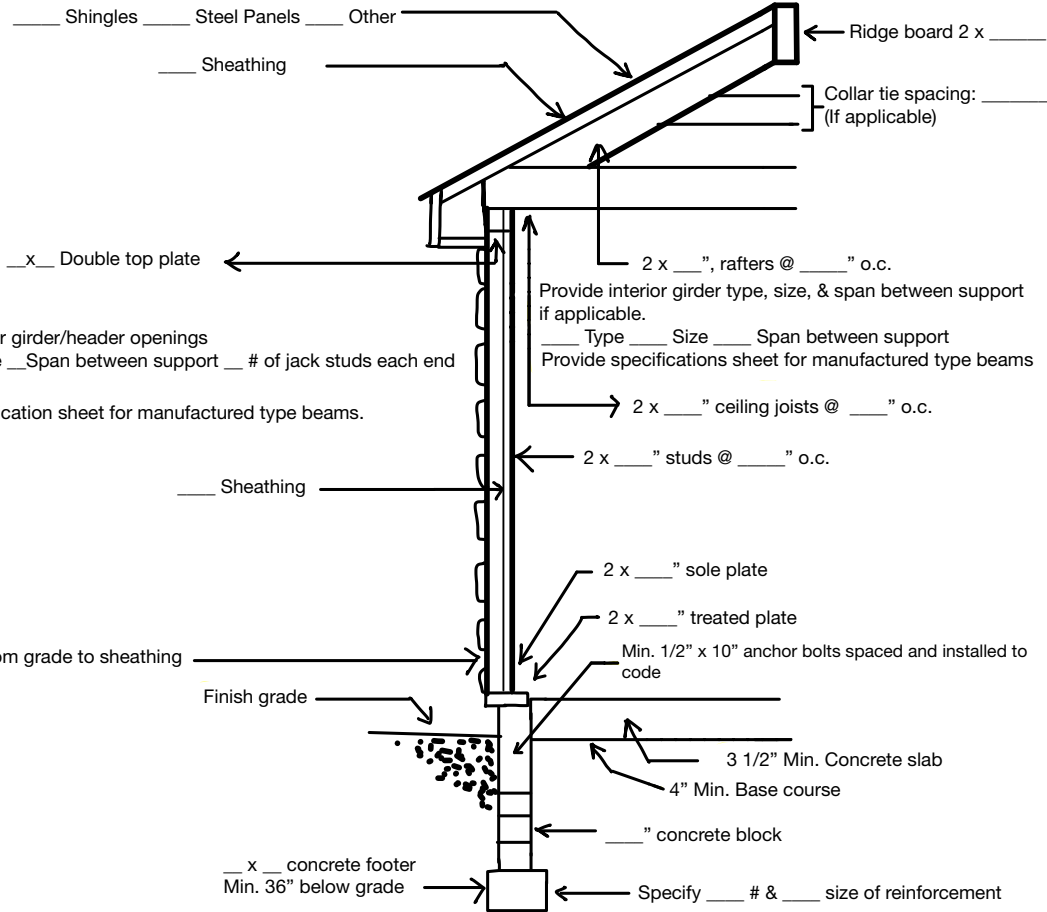

Permanent Heating Supply \_\_\_\_\_ No \_\_\_\_\_ Yes If yes, provide specifications on heating and insulation.

Electric \_\_\_\_\_ No \_\_\_\_\_ Yes If yes, provide specifications

Garage floor used for parking of automobiles or other vehicles shall be sloped to a \_\_\_\_\_ drain/drains or \_\_\_\_\_ toward the main vehicle entry door/doorways to facilitate the movement of liquids.